

MEDIT

CART

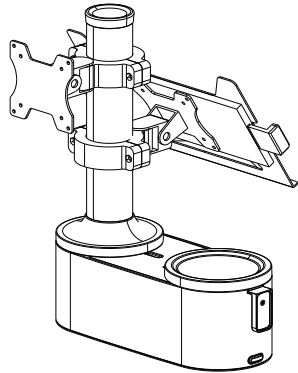

MEDIT CART



MONITOR
ATTACHMENT



USER GUIDE

Revision 0 (Dec 2024)

CONTENTS

1. Introduction
- 1.1. Intended Use
2. Specification
3. Installation
- 3.1. MEDIT CART
- 3.1.1. Components
- 3.1.2. Assembly Instructions
- 3.2. MONITOR ATTACHMENT
- 3.2.1. Components
- 3.2.2. Assembly Instructions
4. Safety Information
- 4.1. Precautions
- 4.1.1. Maximum Load Capacity of MEDIT CART
- 4.1.2. Maximum Load Capacity of MONITOR ATTACHMENT
5. Compliance
- 5.1. RoHS 2 Compliance
- 5.2. ASTM D4169

1. INTRODUCTION

1.1. INTENDED USE

Medit Cart is intended to hold items on top and store items in three different compartments according to the user's preference.

If they purchase the Monitor Attachment, the user can attach a monitor and a laptop to the Monitor Attachment after replacing the top part of the cart with the Monitor Attachment.

2. SPECIFICATIONS

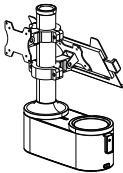
Product Name		MEDIT CART	MONITOR ATTACHMENT
Model Name		MCT1	MCT1-MA1
Image			
Dimensions (L x W x H)	Hardware	650 x 400 x 782 mm	355 x 145 x 470 mm
	Package	770 x 470 x 675 mm	590 x 475 x 240 mm
Weight		25 kg	5.54 kg
Material	Body	Polycarbonate	Polycarbonate
	Base	Aluminum	Not applicable
	Pipe <small>(Inside the Storage Components)</small>	Stainless Metal	Not applicable
	Pipe <small>(In the MONITOR ATTACHMENT)</small>	Not applicable	Aluminum
Load Capacity (L x W x H)	Power Strip Area	200 x 120 x 90 mm	200 x 120 x 94 mm
	Storage Compartment <small>(Swing-out Drawers)</small>	200 x 130 x 89 mm	Not applicable
	Storage Compartment <small>(Base Cabinet)</small>	220 x 130 x 230 mm	Not applicable
Off-the-Shelf Products Included	Caster	Ø75	Not applicable
	Clamp	Not applicable	114 x 114 x 140 mm
	Laptop Holder	Not applicable	310 x 218 x 38 mm

3. INSTALLATION

Before assembling this cart, carefully review the following instructions carefully to ensure safety and stability.

Once assembled, place the cart on a flat surface and check for stability before use. Regularly inspect and tighten all parts to ensure safe and prolonged use. Serious injury may occur if the cart tips over, so it is important to follow the assembly steps carefully.

3.1. MEDIT CART

3.1.1. COMPONENTS

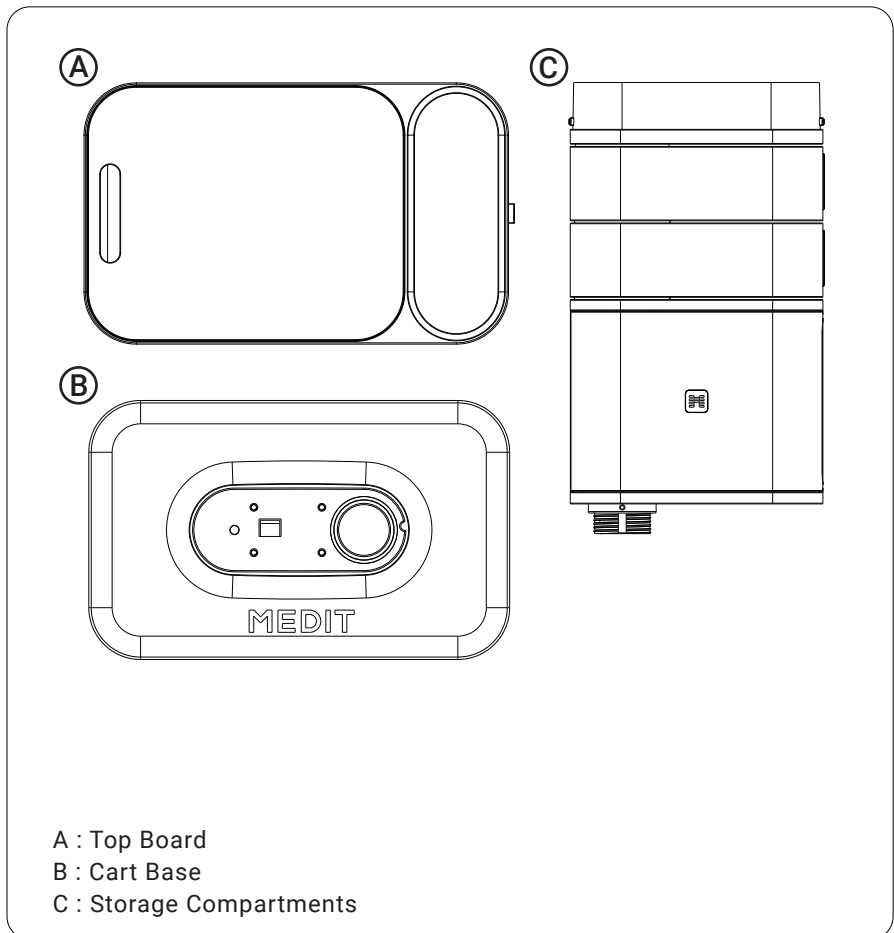

(D)

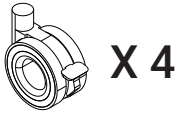

(E)



(F)



(G)



(H) M10 X 30



(I)



(J)

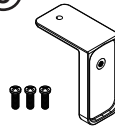

(K)



D : Casters

E : Castle Nut

F : Open-end wrench

G : Bolts L-wrench

H : Bolts

I : Caps

J : L-bracket + 3 Bolts (1 Set)

* This bracket and bolt are for spare use. The L-shaped bracket is pre-installed during packaging.

* Installing the L-bracket requires two bolts; an additional spare bolt is also provided.

K : User Guide

3.1.2. ASSEMBLY INSTRUCTIONS

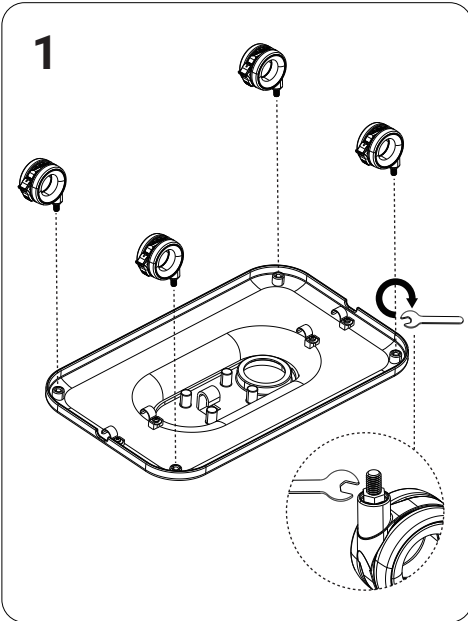

1. Assemble the 4 Casters (D) onto the Cart Base (B) using an Open-end wrench (F).

1-1. Please align the Open-end wrench (F) with the hex nut on the bottom of each Caster (D) and tighten it.

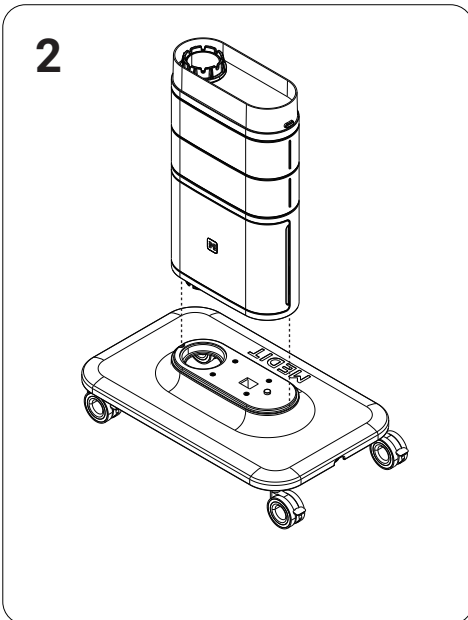

2. Place the Storage Compartments (C) on top of the Cart Base (B) as shown in the illustration.

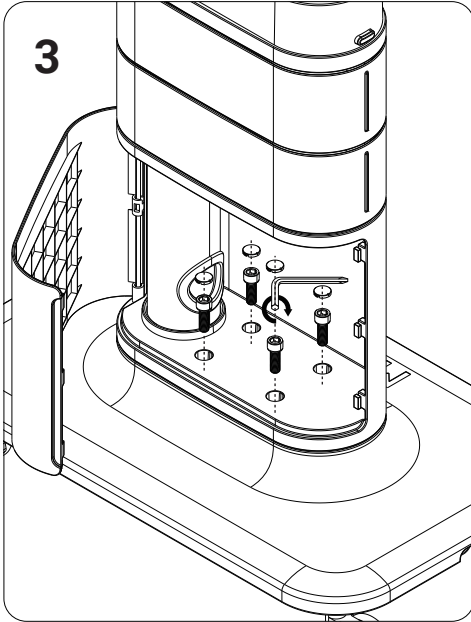

3. Open the base cabinet of the Storage Compartments (C). Inside, you will find four holes to fasten the bolts (H) to the Cart Base (B). Please fasten the bolts (H) into each hole with an L-shaped wrench (G). Once tightened, position the Cap (I) on the bolts.

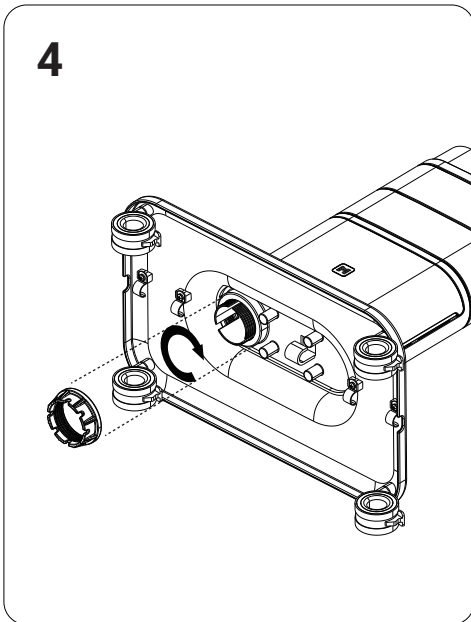

4. After fastening the Bolts (H), lay the cart on its side and secure the Castle Nut (E) to the pipe in the Storage Compartments (C) from the bottom. Tightening may feel stiff, but it is essential for the cart's stability. Ensure the axis remains properly aligned. Caution: The pipe where the castle nut (E) is to be mounted has sharp edges that may cause hand injuries. Always wear gloves during this step.

5

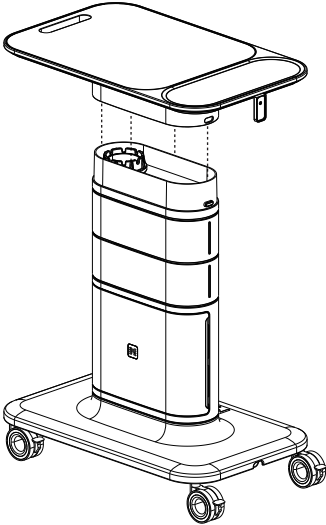

5. After setting the cart upright, secure the Cart Board (A) onto the top surface of the Storage Compartments (C).

6

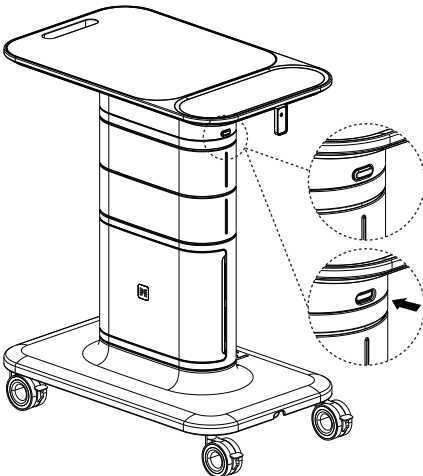

6. The Cart Board (A) is supported by injection-molded components and blue spring buttons on both sides of the Storage Compartments (C). During assembly, press the blue spring buttons to securely attach the Cart Board (A). The spring tension is designed to enhance the cart's stability, so it may feel somewhat stiff when pressing the buttons.

7

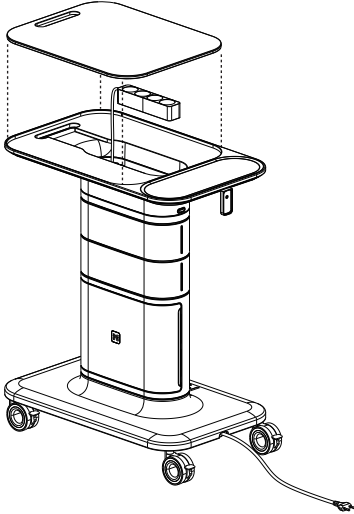

7. Remove the cover of the Cart Board (A) to access the power strip area underneath. Arrange the power strip and route its power cable through the pipe of the Storage Compartments (C) and under the Cart Base (B) to keep them organized. Connect the power cables from your devices to the power strip inside the top board through the gap in the lid handle.

8

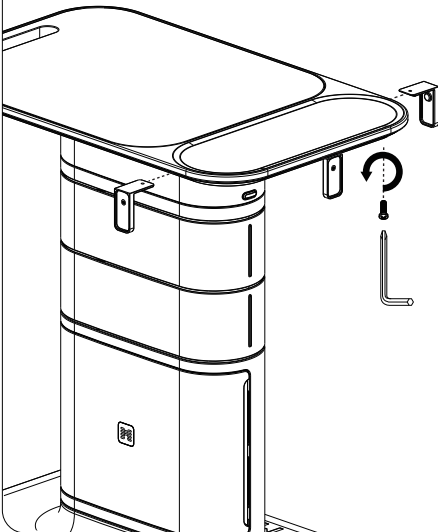

8. There are 3 holes on three sides of the top board (A) to install the L-bracket (J).
- 8-1. The L-shaped bracket is shipped pre-assembled in the side hole opposite the handle space. If you want to install it on one of the two other sides, unscrew the bolts from the bottom of the Top Board (A) with an L-shaped wrench (G), move the L-shaped bracket (J) to the desired location, and retighten the bolts.

3.2. MONITOR ATTACHMENT

3.2.1. COMPONENTS

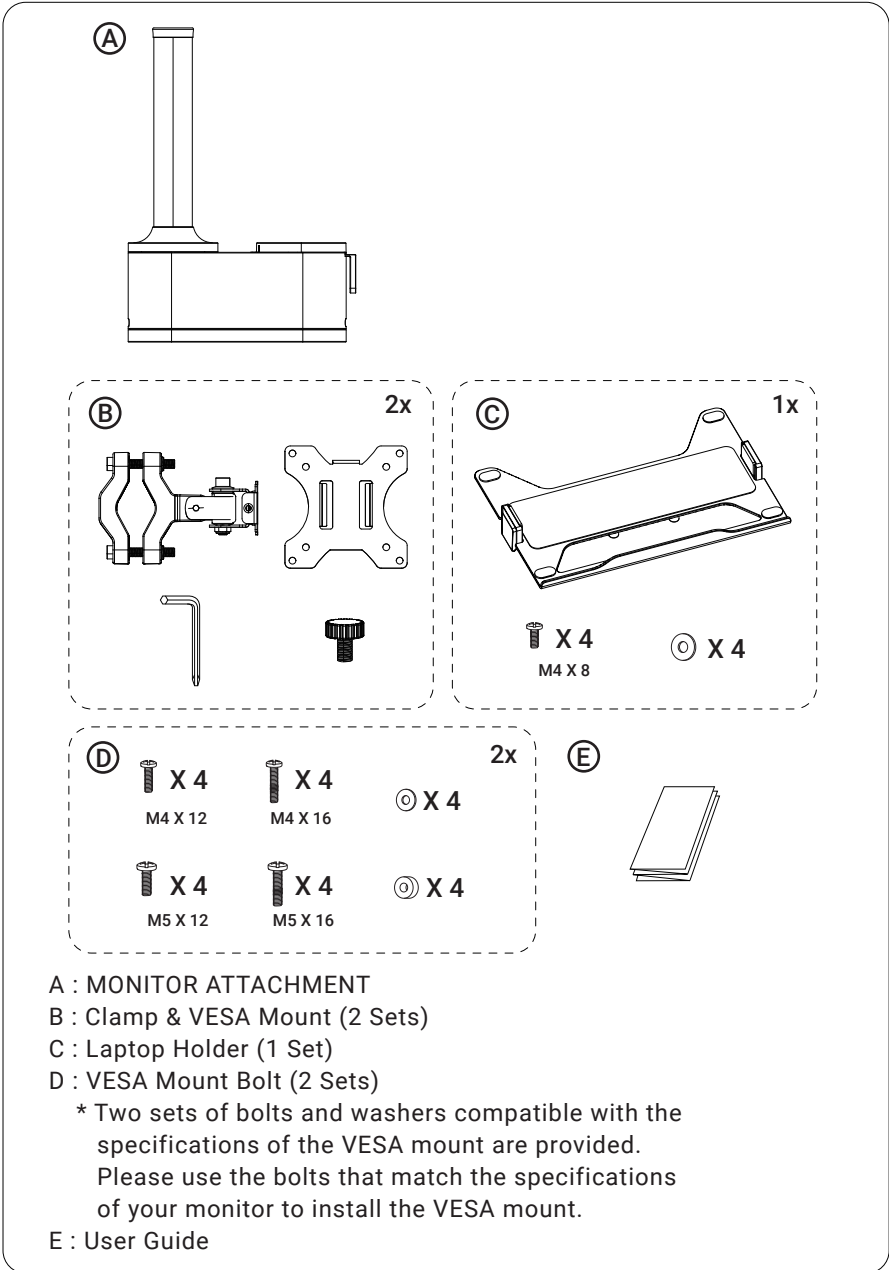

3.2.2. ASSEMBLY INSTRUCTIONS



1. If the top board, which is included as a standard part of the cart, is already assembled, detach it by pressing the blue spring buttons and pulling out the Top Board.



2. Secure the MONITOR ATTACHMENT (A) onto the top surface of the Storage Compartments.

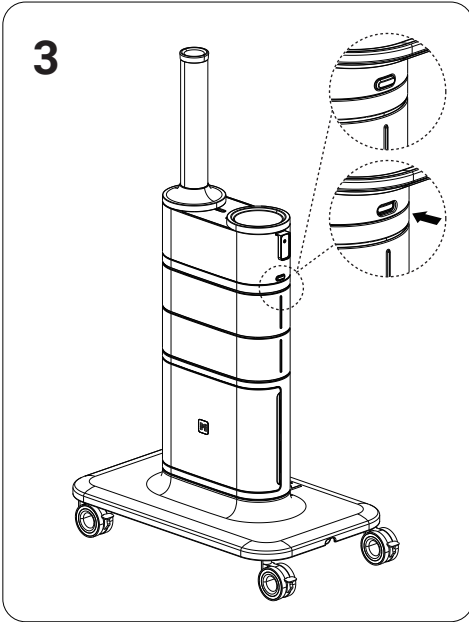

3. MONITOR ATTACHMENT (A) is supported by the injection-molded components and the blue spring buttons on both sides of the Storage Compartments. During assembly, press the blue spring buttons to securely attach the MONITOR ATTACHMENT (A). The spring tension is designed to enhance the cart's stability, so it may feel somewhat stiff when pressing the buttons.

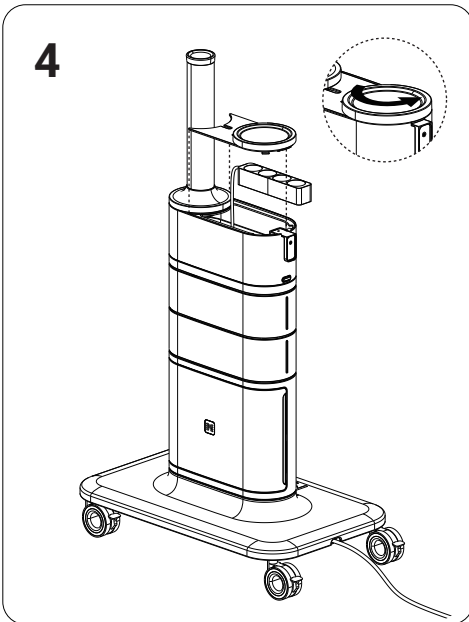

4. Inside the MONITOR ATTACHMENT(A), there is a space for a power strip.
- 4-1. Unlock the round-shaped cover at the top right corner of the attachment by turning it counterclockwise.
- 4-2. Arrange the power strip inside and route its power cable through the pipe in the Storage Compartments and under the Cart Base to keep them organized.
- 4.3 Connect the power cables from your devices to the power strip inside the MONITOR ATTACHMENT (A).
- 4-4. Lock the cover by turning it clockwise.

5

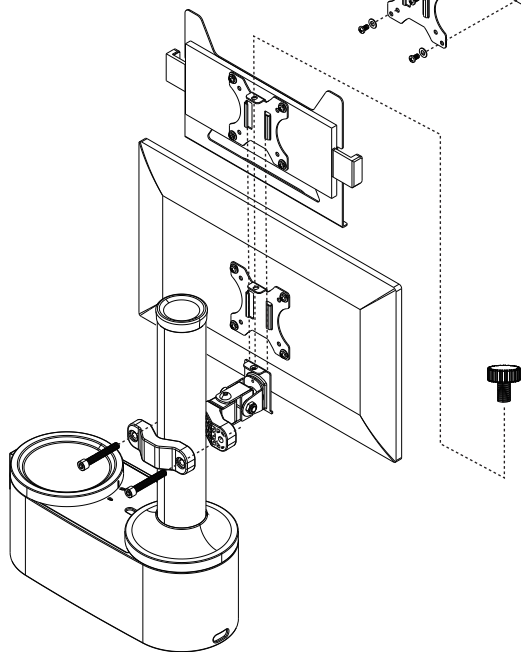
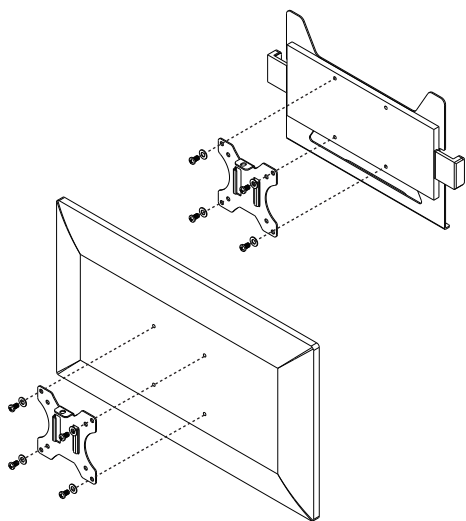
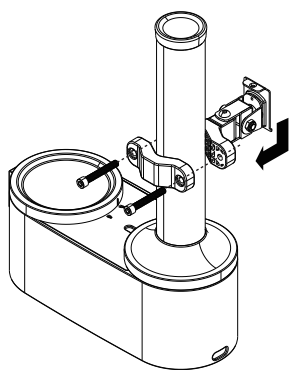

- 5-1. After installing MONITOR ATTACHMENT (A), Attach the clamp to the pipe, ensuring that the bracket of the joint section, which will connect to the VESA mount (B) is facing downward.
- 5-2. Attach the VESA Mount (B) to your monitor and the Laptop Holder (C). Use the appropriate size of bolts and washers from set D for the monitor and from set C for the Laptop Holder (C).
- 5-3. Insert the VESA Mount (B) into the joint on the clamp.
- 5-4. Use the screws from Set B to firmly tighten the VESA Mount and Clamp (B).

4. SAFETY INFORMATION

4.1. PRECAUTIONS

4.1.1. MAXIMUM LOAD CAPACITY OF MEDIT CART

The storage compartments have a maximum load capacity of 4 kg, and the base cabinet can support up to 10 kg.

4.1.2. MAXIMUM LOAD CAPACITY OF MONITOR ATTACHMENT

Each clamp (for monitor and laptop) supports a maximum load of 8kg, and the laptop holder itself weighs 700 g. Therefore, the maximum load capacity for a monitor is 8kg, while the maximum load for a laptop is 7.3kg. The recommended laptop size range is from 11.6 to 17.3 inches.

5. COMPLIANCE

5.1. ROHS 2 COMPLIANCE

The MEDIT CART and the MONITOR ATTACHMENT comply with the Restriction of Hazardous Substances (RoHS) 2 Directive 2011/65/EU, 2015/863/EU, which restricts the use of specific hazardous substances in equipment. It meets the requirements for the following substances:

- Cd
- Pb
- Hg
- Cr
- Br
- PBBs
- PBDEs

The products have been tested and certified for RoHS 2 compliance, ensuring adherence to environmental and safety standards.

- Test Report No.: NICERD240712.0129
- Certification Body: iNice
- Date of issue: Aug 14, 2024

5.2. ASTM D4169

The MEDIT CART and the MONITOR ATTACHMENT have successfully passed the ASTM D4169 transportation test, ensuring that the products provide reliable durability and performance during shipping and handling.

INFORMATION

Medit Corp

9F, 10F, 13F, 14F, 16F, 8, Yangpyeong-ro 25-gil,
Yeongdeungpo-gu, Seoul, 07207,
Republic of Korea
Tel: +82-02-2193-9600
support@medit.com

Model Solution

1F, 2F, 5F, 14, Saneop-ro 104beon-gil, Ojeong-gu,
Bucheon-si, Gyeonggi-do,
Republic of Korea

Made in Korea



www.medit.com | © Medit 2024

